

RoofReflex Insulated Breather Membrane

Product Description

Roofreflex is an insulated roof and wall underlay membrane that is both airtight and vapour open. It is CE approved as a breathable membrane and is fully EN 1928 W1 waterproof compliant. Roofreflex is normally used in conjunction with other standard insulation products to enhance the achieved U-value of any installation. Reflective and highly vapour permeable membrane a 37mm thick, compressive layer of moisture-proof polyester fiber with a thermal conductivity of λ 0.0366W/(m.K).

Features

- CE compliant to EN 13859 -1 and -2
- Integral lap tapes
- Insulated and breathable roof and wall underlay membrane
- Low emissivity external face
- Acoustic benefits
- Reduces thermal bridge losses
- Fully airtight when installed with the supplied integral tapes
- Reduces overheating in summer
- Adds up to 1.47 in extra R-value
- Single product suitable for both roofs and walls
- Lower install costs than PIR systems
- Main Novia Reflex tested for BS 5534 wind uplift
- 10 year warranty

Typical Applications

- U values improving
- Integrated insulation layer
- Roof
- Wall

	Value
Standard Width	1.4m
Roll Length	10m
Nominal Weight	730g/m ²
Thickness of the polyester fiber	37mm
Operating temperature range	-40°C to +80°C
Fire resistance classification	E (EN 13501-1)
Thermal core resistance	R = 1.00 m ² .K/W
Thermal conductivity	λ = 0.0366 W/(m.K) (EN 12667)
Thermal resistance together with 1 unventilated air gap, wall horizontal heat flow	R = 1.47 m ² .K/W

Premier Sealant Systems Ltd.

T 01724 864 100 | E sales@sealprem.com | www.sealprem.com

Mercia Way, Foxhills Industrial Park, Scunthorpe, DN15 8RE

Registered in Cardiff No. 3000843

Resistance to water penetration	W1 (EN 1928)
Tensile strength (Longitudinal)	220 to 360 N/50 mm (EN 12311-1)
Tensile strength (Transverse)	150 to 275 N/50 mm (EN 12311-1)
Tear resistance (Longitudinal)	120 to 230 N (EN 12310-1)
Tear resistance (Transverse)	175 TO 280 N (EN 12310-1)
Elongation (Longitudinal)	55 to 100 % (EN 12311-1)
Elongation (Transverse)	70 to 150% (EN 12311-1)
Sd value	< 0.061 m (±0.01) (EN 12572)
Emissivity	0.18 (EN 15976)
Emissivity (aged)	0.19 (EN 16012)
Resistance to air penetration	0.000 m ³ /m ³ .h.50.pa
Vapour resistance external layer	0.25 MNs/g
Vapour resistance insulation layer	0.05 MNs/g
Vapour resistance Roofreflex	0.3MNs/g

Roof Installation Guidance:

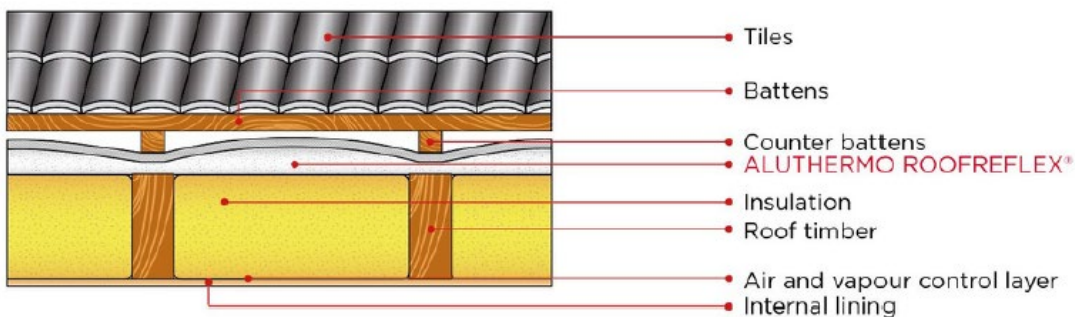

Wall Installation Guidance:

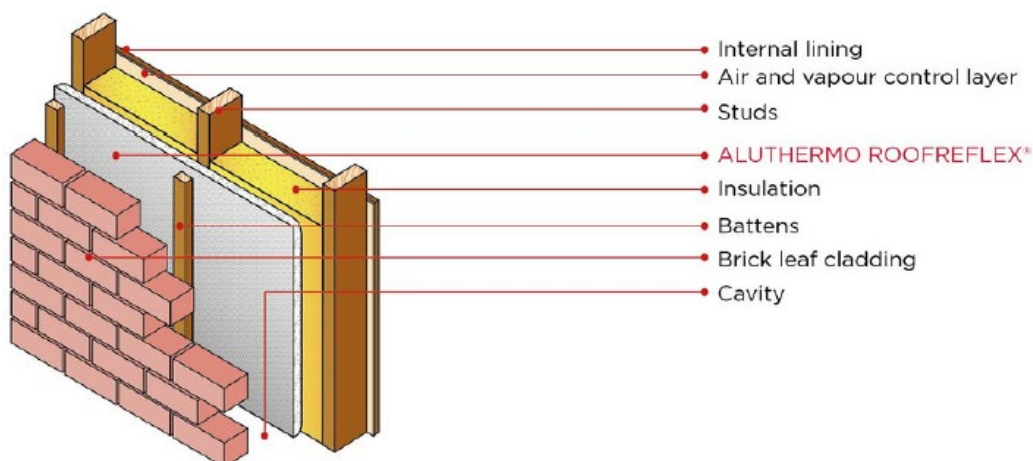

Please note: The above technical information is given as a guide and is based on recent test data obtained under laboratory conditions. Materials should be fully tested by the end user to establish suitability of the product for the intended application. March 2024

Premier Sealant Systems Ltd.

T 01724 864 100 | E sales@sealprem.com | www.sealprem.com

Mercia Way, Foxhills Industrial Park, Scunthorpe, DN15 8RE

Registered in Cardiff No. 3000843